

[www.zubr.ru](http://www.zubr.ru)



Instruction Manual

# Table Saw

ZPDS-200-800

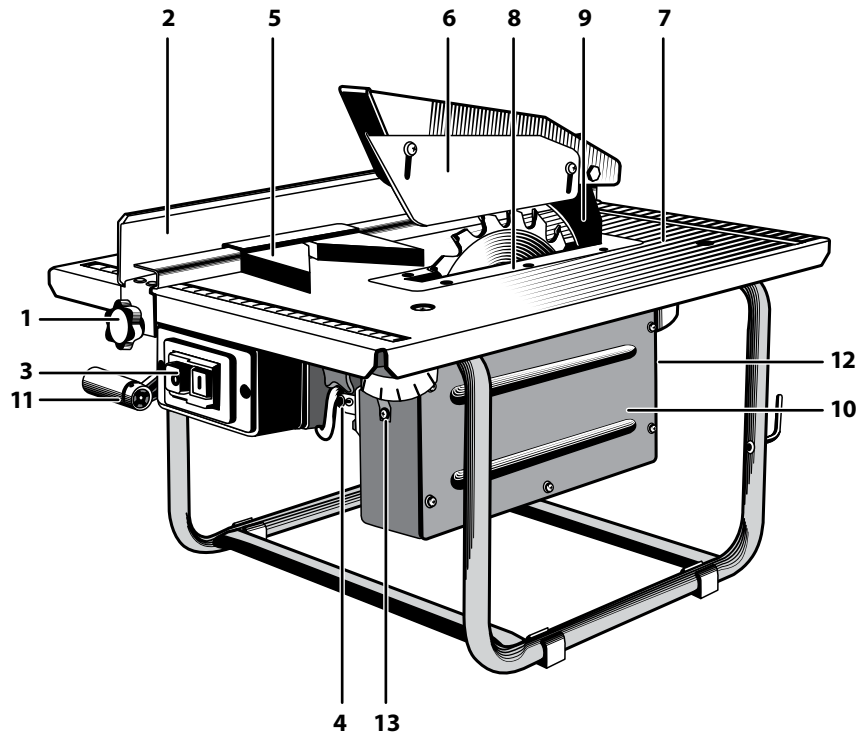

## Dear customer!

When buying the product:

- Request a functional check of the product by a test run as well as completeness of its parts according to the delivery set;
- Make sure that the warranty card is properly issued and contains the serial number of the product, the date of sale, the shop stamp and the seller's signature;

Before you turn on the product for the first time, please read this manual carefully and strictly follow its requirements. This is the only way to learn how to handle the product correctly and avoid errors and dangerous situations. Keep this manual for the entire service life of your product.

**Remember!** The product is a source of increased traumatic danger.

## ⚠ ATTENTION

Separate parts of the product become hot during operation and touching them can cause burns.

Using the product in industrial and commercial environments, under high intensity of work and extra heavy loads reduces the service life of the product.

The product is intended for residential use in areas with moderate climate with typical temperature from  $-10^{\circ}\text{C}$  to  $+40^{\circ}\text{C}$ , relative humidity not exceeding 80%, lack of direct exposure to precipitation and excessive dust.

The product meets the requirements of the Technical Regulations of the Customs Union:

- TR CU 004 / 2011 "On safety of low-voltage equipment" Art. 4, paragraphs 1-5, 9;
- TR CU 020/2011 "Electromagnetic compatibility of technical means" Art. 4, paragraphs 2, 3.

This manual contains the most complete information and requirements necessary and sufficient for reliable, efficient and safe operation of the product.

In connection with the continuing improvement of the product, the manufacturer reserves the right to make minor changes in its design that are not reflected in this manual and do not affect the effective and safe operation of the product.

## Purpose and scope

Desktop circular saw is designed for sawing wood workpieces at various angles as well as tilting.

Please read these operating instructions carefully, including the "Safety Instructions" section and the "General Safety Instructions" appendix. This is the only way you can learn how to handle the tool correctly and avoid errors and dangerous situations.

## Specifications

Parameter	ZPDS-200-800
Rated power, W	800
Rated no load speed, rpm	2950
Rated voltage, V/Hz	220±10%/50
Diameter of saw blade, mm	200
Bore diameter of saw blade, mm	30
Maximum sawing depth, mm:	tilt 90°– 40 tilt 45°– 25
Range of bevel angle, degrees	0–45
Diameter of dust extraction nozzle, mm	30
Table size, mm	500 x 337
Sound pressure level (k = 3), dB	86
Sound power level (k = 3), dB	97
RMS acceleration (k = 1.5), m / s <sup>2</sup>	2.3
Protection class	I class
Netto weight, kg	13
Brutto weight, kg	15
Service life, years	5

## Contents of delivery

Circular table saw	1 pc
Saw disc (installed)	1 pc
Longitudinal guide with fasteners	1 kit
Corner stop (protractor)	1 pc
Nut wrench	2 pcs
Handle	1 pc
Pusher	1 pc
Safety instructions	1 copy
Instruction manual	1 copy

### ⚠ ATTENTION

Make sure that there are no visible mechanical damage to the product and accessories that may have occurred during transport.

## Operating Instructions

### Parts of the product

- 1 Guideway screw
- 2 Longitudinal guide
- 3 Power switch
- 4 disc tilt screw (front and rear)
- 5 Cornerstone
- 6 Protective cover
- 7 Sawing desktop
- 8 Table insert
- 9 Splitter
- 10 Disc body cover
- 11 Wheel tilt mechanism handle
- 12 Dust pipe (back)
- 13 Tilt angle scale

### Product assembly

#### ⚠ ATTENTION

All assembly, replacement and adjustment work must be carried out only when the product is disconnected from the mains.

Place the supplied handle 11 on the tilt adjustment shaft and fix it with screw.

Check and (if necessary) adjust the position of the splitter 9. Its plane must coincide with the plane of the disc, the gap between the disc and the splitter must be 2-5 mm.

Adjustment of the splitter:

- Remove the mounting screws for table insert 8 and remove the insert;

- Release the tilting mechanism of the disc by loosening the screws 4;

- By rotating the handle 11, tilt the disc as much as possible;

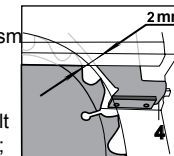

- Loosen the two retaining screws for the splitter and adjust the position and clearance between the splitter and disc. Firmly tighten the retaining screws of the splitter;

- Place the table insert back in place and fasten it with the screws.

#### ⚠ ATTENTION

It is **PROHIBITED** to use the product without the splitter.

Installation (if not installed) of the cover 6 for the disc:

- Place the cover on the disc and the splitter and secure it with the thumb screw in the opening of the splitter.

#### ⚠ ATTENTION

It is **PROHIBITED** to use the product without the protective cover.

Installing (if necessary) the longitudinal guide:

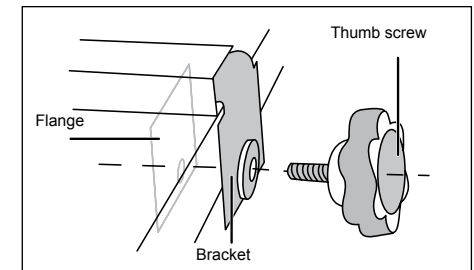

- unscrew the thumb screws on the guideway and remove the clamping flanges;

- Place the guide on a table parallel to the plane of the disk on the desired side of the disk;

- Install the removed clamping flanges on the inside of the table and tighten them to the guide mounting brackets with the screws.

- The product has a standard wood saw disc on it. If it is necessary to install a disc suitable for other type of work, replace the disc.

To do so:

- Remove the cover 10 of the disc housing by unscrewing the retaining screws;

#### ⚠ ATTENTION

To avoid injury and damage, we **STRONGLY** recommend you to work with the saw disc **ONLY** in protective gloves.

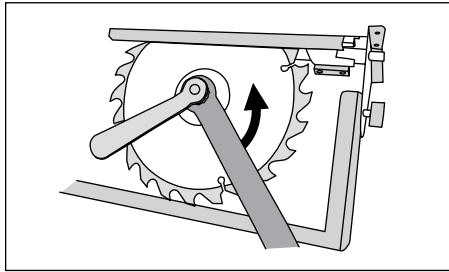

- By turning the handle **11** clockwise or counterclockwise, set the required cutting angle according to the indicator scale **13**;

- Fix the tilt of the disc with the screws **4**.

If you need to create forced dust extraction, connect the hose to the dust outlet of the cleaner. The outer diameter of the dust outlet is 30 mm. You may need an adapter (not included) to connect to your cleaner.

Prepare yourself for work:

- Prepare and out on protective equipment (goggles, gloves, earphones);

- Prepare the workpiece to be processed and make sure it is free of metal objects (nails, screws, etc.);

- Take measures to ensure that the workpiece will not bend off (causing uneven cracking or injury when falling);

- Make sure that the saw disc is securely attached to the shaft and is not blocked;

- Remove wrenches and other objects from rotating parts of the product.

- With a smaller wrench, hold the spindle back from turning, use second wrench to unscrew the pressure nut and remove the outer flange;

- Place a saw disc on the spindle that matches the work to be performed;

**Note!** The direction of the disc rotation (indicated on the disc itself) must match the direction of the spindle rotation (indicated on the inside of the disc housing).

- Install the outer flange and use the wrenches to tighten the pressure nut;

- Replace the disc body cover.

## Preparing for work

The product has a standard wood saw disc on it. If it is necessary to install a disc suitable for other type of work, replace the disc.

Depending on the work to be done, adjust the position of the longitudinal guide:

- loosen the screws securing the guide;

- According to the scale on the workbench, install the guide rib according to the width of the sawn-off part;

- Lighten the fixing screws.

If it is necessary to saw the workpiece at an angle of 45 degrees, install the cornerstone 5 on the guide.

- If it is necessary to saw the workpiece with a slope at an angle of 45 degrees, you need to:

- Loosen the screws 4 that secure the tilt of the disc;

## Operating Procedure

### ⚠ ATTENTION

Connect the product to the power supply.

**For electrical safety, the product complies with class I protection against electric shock, i.e. it must be earthed (grounding contacts are provided in the plug for this purpose). Do not remake the plug if it does not fit into your outlet. Instead, a qualified electrician must install the appropriate socket.**

The product can be switched on by pressing button "I" of the switch 3.

**Note!** The switch of the product is of electromagnetic type. If there is a loss of mains voltage and the product does not turn on itself afterwards. To switch on the product in this case press again the "I" button.

Place one end of the workpiece on the worktable, press it to the guide (with the adjusted sawing width) and start feeding (with a pusher) the workpiece to the disc.

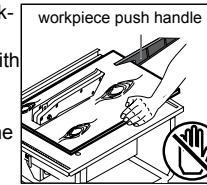

### ⚠ ATTENTION

**To avoid injury or damage to the operator, do not fold the cover of the disc when feeding the workpiece - it will open automatically.**

### ⚠ ATTENTION

**Always use the supplied pusher to feed the workpiece for greater safety.**

When sawing at a angle of 45, "insert" the workpiece angle into stop 5. Use the slide of the stop to feed the workpiece.

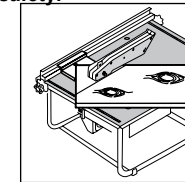

Observe the engine speed when working on the workpiece. A speed drop of 20% or more indicates an overload. In this case it is necessary to reduce the feed speed of the workpiece.

At the end of work, switch off the product by pressing the "0" button. Disconnect the product from the mains.

### ⚠ ATTENTION

**During operation, the disc heats up. Do not touch it immediately after the end of sawing and until it has cooled down completely.**

Thoroughly remove all waste from the desktop and the protective cover.

### ⚠ ATTENTION

**Do not remove the waste by hand to avoid injury or damage. Use a brush.**

## Periodical maintenance

During operation it is periodically necessary to:

- Replace the saw disc (as it wears out);

- Adjust the position of the splitter.

To find instructions for these actions, see Assembly section.

It is also necessary to periodically (as required) adjust the disc angle indicator during operation. To do so:

- Turn off the product with the switch and disconnect it from the mains;

- loosen the screws 4 that secure the disc angle;

- Set the disc to the vertical position by turning the handle 11;

- Raise the disc cover 6 as high as possible;

- Use the angle bar to set the right angle between the disc plane and the desktop surface;

- Check the indicator 13 of the tilt scale. If it differs from zero, loosen the screw securing the pointer, adjust its position, and then tighten the screw back.

## Operating recommendations

Make sure that the mains voltage matches the rated voltage of the product.

Only switch the product on when you are ready to use it.

Before using the product for the first time, switch it on without load and let it run for 10-20 seconds. If you hear any extraneous noise or smell, or feel excessive vibration during this time, turn off the product, disconnect the power cord from the mains and determine the cause of this malfunction. Do not turn the product on before the cause of the malfunction has been found and corrected.

Provide good lighting, ventilation (large amounts of dust are generated during sawing) and order in the workplace, inadequate lighting and foreign objects can cause damage and personal injury.

To prevent accidents, each time before turning on the product, make sure that:

- The saw blade is securely attached to the shaft and is not locked;

- You have removed all wrenches and foreign objects from rotating parts of the product and from the work area;

- There are no metal objects (nails, screws, etc.) in the workpiece.

In terms of electrical safety, the product complies with class I protection against electric shock, i.e. it must be grounded (for this purpose, grounding contacts are provided in the plug). Do not remake the plug if it does not fit into your outlet. Instead, a qualified electrician must install the appropriate socket.

The product is designed to saw **ONLY** workpieces made of wood and derived materials (plywood, chipboard, fibreboard, MDF, laminated panels).

It is **FORBIDDEN** to saw other materials (metal, ceramics, stone) as well as to install other discs (diamond, abrasive, etc.; with dimensions different from those specified in the product specifications; damaged - with chips, cut teeth, cracks, curved, blunted).

For work, we recommend using consumables of the **3Y6P** company.

To avoid personal injury, **DO NOT** place your hands in the sawing area when operating the product.

**DO NOT** saw workpieces (especially long, with uneven edges) by simply holding them with your hands. **ALWAYS** use a longitudinal guide.

#### DO NOT SAW:

- Round workpieces;
- Workpieces that are so small that you can't hold them;
- Several workpieces at the same time.

Do not apply excessive force when feeding the workpiece to saw. This will not speed up the sawing process, but will only reduce the quality of work and shorten the service life of the product.

Keep an eye on the condition of the saw disc. Replace the saw disc with a new one if there is excessive blade runout (which may be due to vibration, tooth loss or warping due to overheating). Follow the instructions in the assembly section to replace the disc.

To avoid overheating, take sufficient breaks to cool down the product. When working without a connected vacuum cleaner, it is recommended that you take more frequent breaks to clean the inside of the disc cover.

If the disc is jammed, immediately switch off the product with the "0" key and take measures to release the disc. Check the position of the splitter and, if necessary, adjust it (see "Assembly").

Switch the product off immediately after completion of work.

Switch off the product with the "0" key only. Do not switch it off by simply disconnecting the cable from the mains (by removing the plug from the socket).

During operation, the product requires preventive maintenance in accordance with the "Periodical maintenance" section.

Periodically clean the product body and cable, as well as ventilation openings from dirt and dust.

All maintenance work must be performed with the cable disconnected from the mains.

The product does not require any other special maintenance.

All repair work must be carried out only by specialists of service centers. Make sure that the product is in good condition. In the event of suspicious smells, smoke, fire or sparks, the product must be switched off, unplugged from the mains and you must contact a specialized service center.

If you find something abnormal in the product's operation, stop using it immediately.

Due to the technical complexity of the product, the criteria for limit states cannot be determined by the user independently. In the event of an apparent or suspected malfunction, refer to the section "Possible Malfunctions and troubleshooting". If there is no malfunction in the list or you could not solve it, contact a specialized service center. The service center issues an opinion on the limiting condition of the product or its parts in the form of the corresponding Act.

## Safety Instructions

All work on the assembly, adjustment and replacement of consumables should be done only when the product is disconnected from the mains.

To avoid accidents, each time before connecting the product to the mains, make sure that:

- You have removed all wrenches and other foreign objects from the rotating parts of the product;
- The saw disc is correctly positioned (in the direction of rotation part) and securely fastened;
- There are no metal objects (nails, screws, etc.) in the workpiece.

In the terms of electrical safety, the product complies with the I class of protection against electric shock, i.e. it must be grounded (for this purpose, grounding contacts are provided in the plug).

Do not modify the plug if it does not fit into your socket. Instead, a qualified electrician must install the appropriate socket.

Do not allow unauthorized persons or children to be in the work area.

The product is designed for use **ONLY** with saw discs.

**DO NOT INSTALL** other discs (diamond, abrasive, etc. discs) on the product. Do not use a disc that does not meet the technical specifications of this product (in particular, in terms of speed, outer or landing diameter). Do not use the tool which is heavily worn or have visible mechanical damage (chips, cracks).

To prevent injury and damage, do not fold the disc cover back when the workpiece is being fed to the disc – the cover will open automatically.

#### DO NOT SAW:

- Round workpieces;
- Workpieces that are so small that you can't hold them;
- Several workpieces at the same time.

During operation, the disc heats up. Do not touch it immediately after you have finished cutting and until it has cooled down completely.

To avoid injury or damage, do not remove sawing waste by hand. Use a brush.

Check the condition of the supply system cable at regular intervals. Avoid damage to the insulation, contamination by aggressive and conductive substances, excessive pulling and bending loads.

The damaged cable must be replaced immediately by a service center.

Wear personal protective equipment when working under adverse conditions (dust, increased noise and vibration).

## Warranty obligations

We constantly take care of improving the quality of service for our customers, so if you have any complaints about the quality and timing of warranty repairs, please inform the 3Y6P support team by e-mail to: [cs@kraftool.hk](mailto:cs@kraftool.hk).

This warranty does not limit the buyer's right to claims arising from the contract of sale, nor does it limit the legal rights of consumers.

### Basic Warranty

The warranty period is 6 months from the date of sale.

We provide a warranty for the 3Y6P instruments on the following conditions:

- 1) The warranty is provided in accordance with the following terms and conditions by eliminating tool faults caused by material defects or manufacturing errors free of charge within the specified warranty period.
- 2) The warranty period starts on the day of purchase of the tool by its first owner.
- 3) The warranty period and conditions depend on the series and article code of the tool, please read the warranty conditions carefully at the time of purchase.

4) The warranty does not apply to:

a) Parts subject to working and other types of natural wear as well as to tool faults caused by these types of wear, and to tools with expired service life, severe external or internal contamination.

b) Tool malfunctions due to non-observance of the Operating Instructions or due to improper use of the tool during use in environmental conditions beyond those specified in the Operating Instructions, improper working conditions, overloading or insufficient, improper maintenance or care. Unconditional signs of overloading of the product include, but are not limited to: occurrence of running colors, simultaneous failure of the rotor and stator, deformation or melting of parts and components of the product, darkening or charring of the motor wires under the influence of high temperature.

c) When the product is used under conditions of high intensity of work and extra heavy loads.

d) For preventive and technical maintenance work on the tool, such as: lubrication, flushing.

e) Tool malfunctions due to the use of accessories, accompanying parts and spare parts that are not produced by the **3Y6P** company.

f) Mechanical damage (cracks, chips, etc.) and damage caused by exposure to aggressive media, high humidity and high temperatures, entry of foreign objects into the ventilation openings of the tool, as well as damage caused by improper storage and corrosion of metal parts.

g) Accessories, parts used to wear fast and consumables that have deteriorated due to normal wear and tear, such as: drive belts, battery packs, barrels, guide rollers, protective covers, columns, chucks, soles, saw chains, saw bars, sprockets, bars, carbon brushes, knives, saws, abrasives, drills, trimmer lines, etc.

h) Tool which construction has been modified or supplemented.

i) A minor deviation from the declared properties of the tool which does not affect its value and ability to be used for its intended purpose.

j) A tool that has been opened or repaired during the warranty period outside authorized service centers.

5) Troubleshooting, recognized by us as a warranty case, is performed at the 3Y6P company's choice by repairing or replacing the defective tool with a new one (possibly with a next generation model). Replaced tools and parts become the property of the company.

6) Warranty claims are accepted during the warranty period. For this purpose show or send the defective tool to the service center, having attached the check confirming date of purchase of the tool and its name. The tool, transferred to the dealer or to the service center in partially or completely disassembled form, is not subject to the warranty. All risks associated with the transfer and forwarding of the tool to the dealer or service center are borne by the owner of the tool.

7) Other claims, except for the mentioned right to free remedy of defects of the instrument, are not covered by our warranty.

8) After warranty repairs under the terms of an extended warranty, the extended warranty period of the instrument does not extend or renew.

9) Regular maintenance is mandatory for all power tools. The maintenance period is equal to the lifetime of the carbon brush set.

10) The service life of the product is 5 years.

### POSSIBLE MALFUNCTIONS AND TROUBLESHOOTING

Malfunction	Possible reason	Troubleshooting
The product does not turn on	No mains voltage.	Check the mains voltage.
	Faulty switch or other component.	Contact a service center for repair or replacement
	Faulty engine.	Contact a service center for repair or replacement
	Disc or spindle is stuck (in the workpiece)	Release the disc, adjust the splitter (see Assembly) or contact a service center for repair or replacement
The product turns on but does not develop at full speed or operate at full power.	Low mains voltage.	Check the mains voltage.
	Burned winding or breakage in motor winding	Contact a service center for repair or replacement
	Faulty switch or other component.	Contact a service center for repair or replacement
	Disc is jamming.	Release the disc, adjust the splitter (see Assembly) or contact a service center for repair or replacement
The product stopped at work.	No mains voltage.	Check the mains voltage.
	Disc is jammed.	Release the disc, adjust the splitter (see Assembly)
	Faulty switch, engine or other component.	Contact a service center for repair or replacement
Unsatisfactory sawing result.	Saw blade blunted or damaged (chips, lost teeth)	Replace the saw disc (see Assembly).
	The disc is not properly secured and rotates on the shaft.	Tighten the disc mount
	Insufficient power or engine speed (see fault 2)	Follow the steps for fault 2
The product is overheating.	Intensive work mode, work with maximum load	Change the operating mode, reduce the load
	High ambient temperature, poor ventilation, clogged air vents	Take measures to reduce temperature, improve ventilation, clean air vents
	Lack of lubrication, jamming in the mechanism	Contact the service center for repair
	Burned winding or breakage in motor winding	Contact the service center for repair